

| | | |
|---|--------------|--------------|
| SHEET NO. | TOTAL SHEETS | RIGHT OF WAY |
| | | |
| R/W ID. | | |
| UNIFORM PROJECT NO. 08510-000 | | |
| COLLEGE STREET AND 11TH AVE. ROUNDABOUT - BOZEMAN | | |

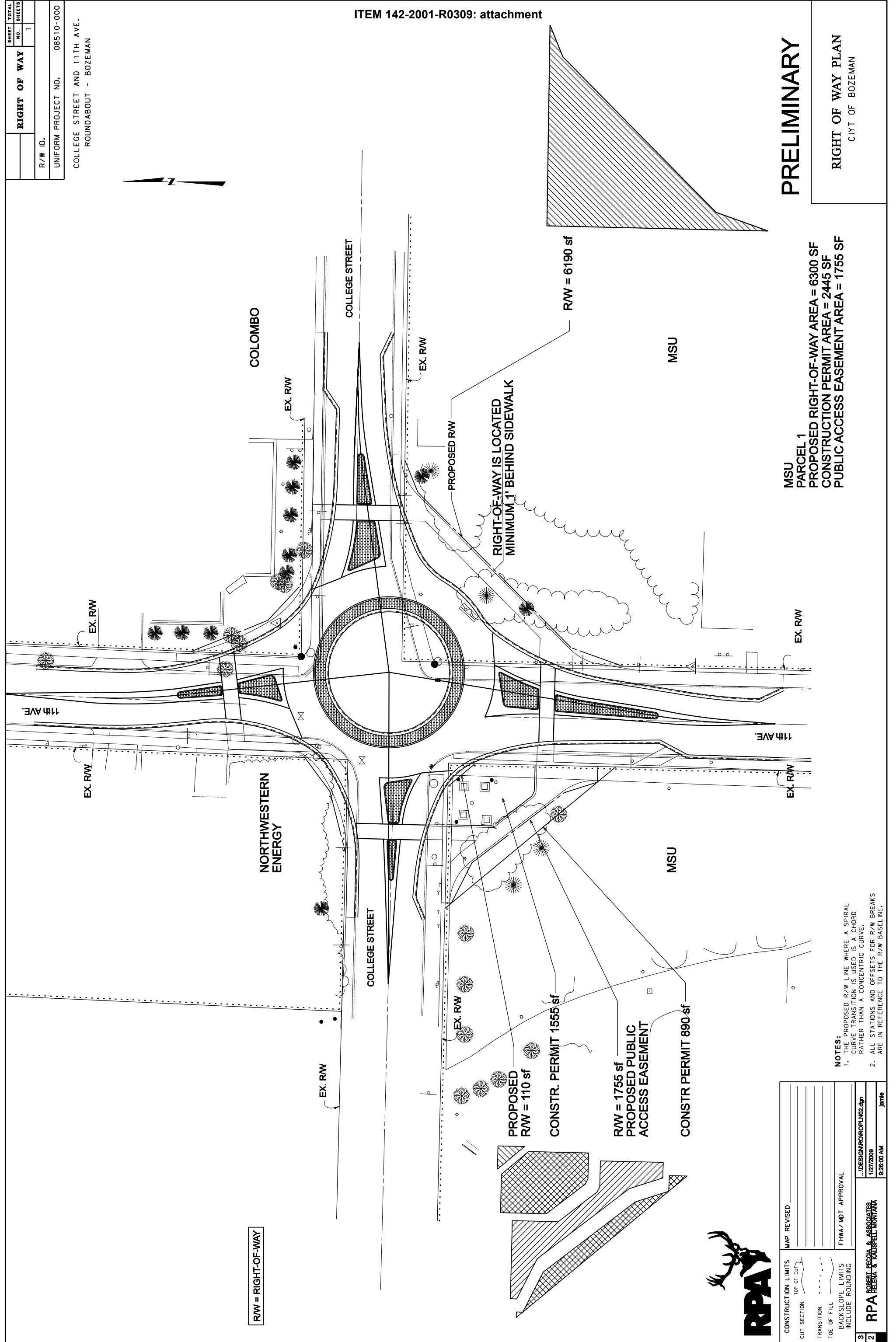
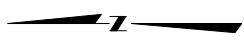

PRELIMINARY

RIGHT OF WAY PLAN
CITY OF BOZEMAN

MSU
PARCEL 1
PROPOSED RIGHT-OF-WAY AREA = 6300 SF
CONSTRUCTION PERMIT AREA = 2445 SF
PUBLIC ACCESS EASEMENT AREA = 1755 SF

- NOTES:**
1. THE PROPOSED R/W LINE WHERE A SPIRAL CURVE TRANSITION IS USED IS A CHORD RATHER THAN A CONCENTRIC CURVE.
 2. ALL STATIONS AND OFFSETS FOR R/W BREAKS ARE IN REFERENCE TO THE R/W BASELINE.

| | |
|-----------------------------------|--|
| CONSTRUCTION LIMITS TOP OF CUT | MAP REVISED |
| | FHWA/MDT APPROVAL |
| TRANSITION | ...DESIGN\RO\ROPLN02.dgn |
| TOE OF FILL | 1/27/2009 |
| BACKSLOPE LIMITS | 9:28:00 AM |
| INCLUDE ROUNDING | jammie |
| 3 | RPA ROBERT BECCA & ASSOCIATES HELENA & KAUSPELL, MONTANA |
| 2 | |

