

# UNIVERSITY OF MONTANA STUDENT LIFE MASTER PLAN

## PROCESS

- Analyze existing campus and focus on areas that impact student life.
- Develop concepts through an iterative, open and conversational process.
- Consider and balance long-term aspirational planning with near-term high demand projects.

## GUIDING STUDENT LIFE MASTER PLAN VALUES

- Increase recruitment & retention.
- Approach Master Plan with a phased mindset focusing on immediate need projects with the biggest impact on student life.
- Focus on spaces and places outside of the classroom that impact student engagement and connectedness with UM's unique culture.
- Celebrate the tremendous natural assets in and around campus and to enhance a student's engagement and connection to place.
- Improve wayfinding & branding as a means to improving the overall experience for students and visitors alike.

# DESIGN APPROACH

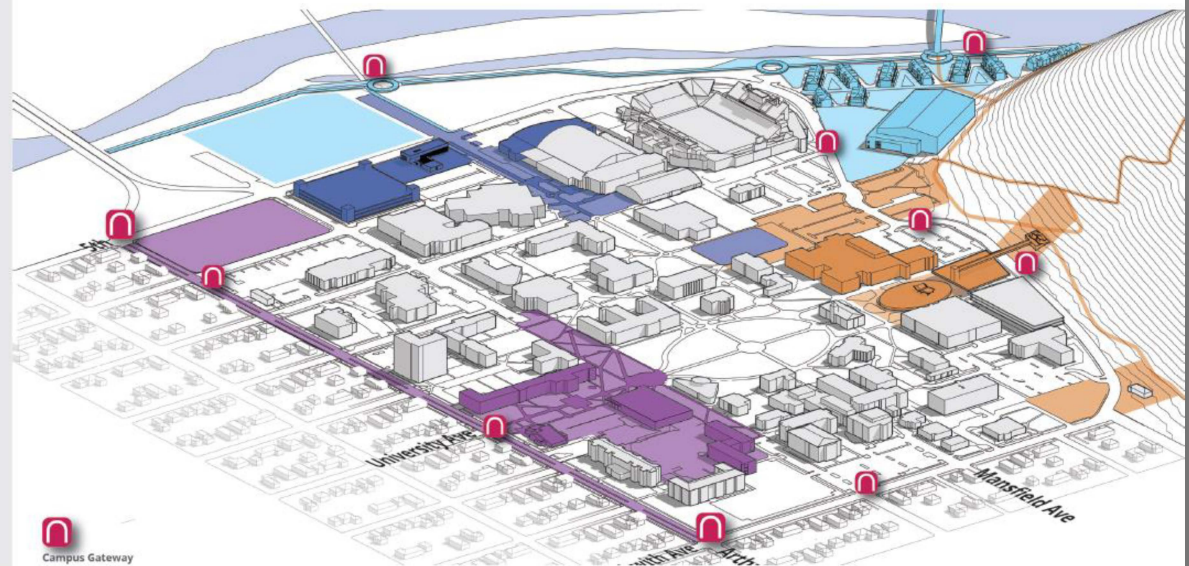



# UNIVERSITY OF MONTANA STUDENT LIFE MASTER PLAN

**FOCUS ON 4 CAMPUS PRECINCTS  
LOOKING FOR SPECIFIC ENHANCEMENTS  
TO INTERCONNECT & AMPLIFY EXISTING  
QUALITIES & STRENGTHS:**

1. Community Connector
2. River
3. Mountain
4. Campus Core

## **CELEBRATE EACH PRECINCT BY:**

- Welcoming its identity & contribution to UM.
- Celebrate the uniqueness each precinct can bring to student experience at UM.
- Reinforce & enhance connections between all precincts.

# DESIGN APPROACH

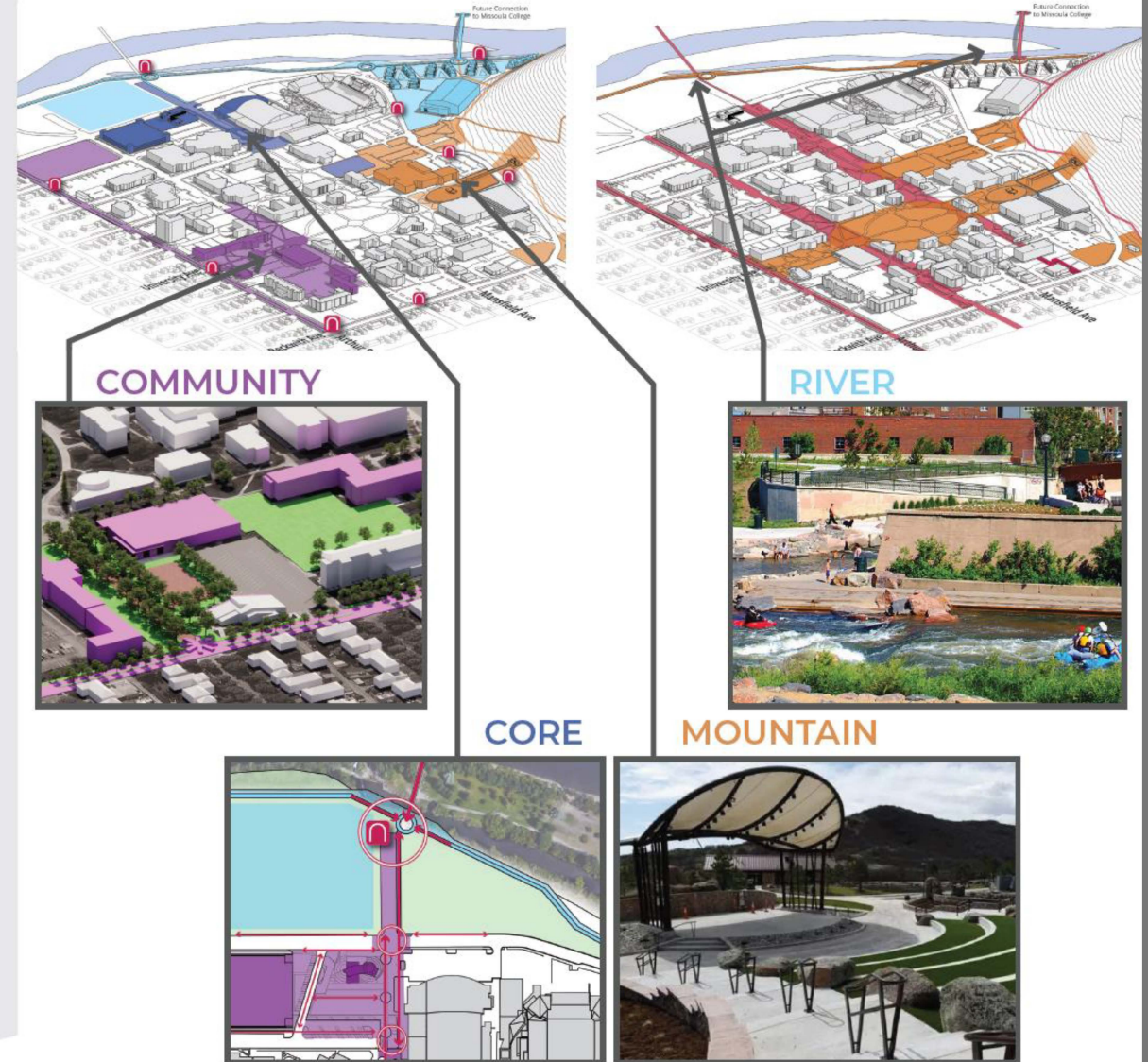



# UNIVERSITY OF MONTANA STUDENT LIFE MASTER PLAN

## THE PROJECT

# NEW DINING HALL

## WHAT DOES IT ENTAIL?

A new campus dining experience that will reach the entire university and community. The location at the intersection of Ryman Walk and the Grizzly Statue will create a vibrant campus hub with a state-of-the-art kitchen, modern dining amenities, garden space, dining and study spaces.

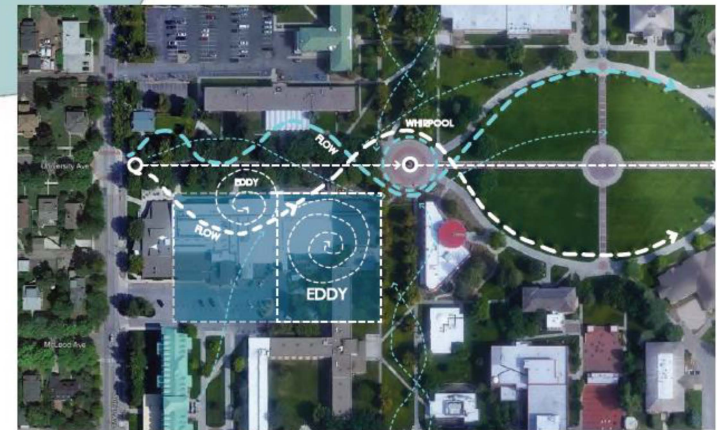
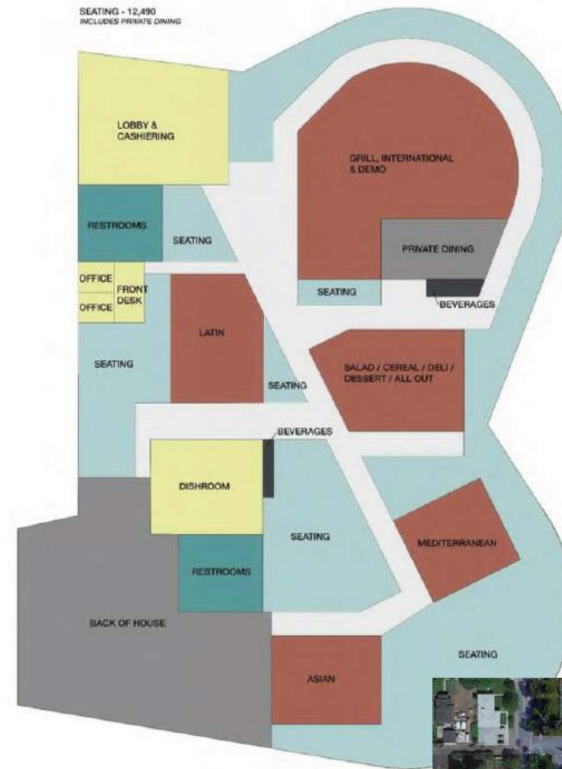
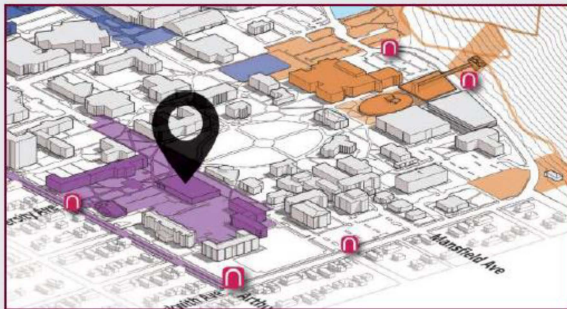

These diagrams and plans are preliminary Schematic Design plans and concepts, and do not reflect the finished design.

# UNIVERSITY OF MONTANA STUDENT LIFE MASTER PLAN

## THE PROJECT

# KNOWLES HALL RENOVATION

## WHAT DOES IT ENTAIL?

This well-liked residence hall, in a prime campus location, will be renovated and modernized with upgraded energy and water performance, enhanced technology infrastructure, and will improve and update common spaces.

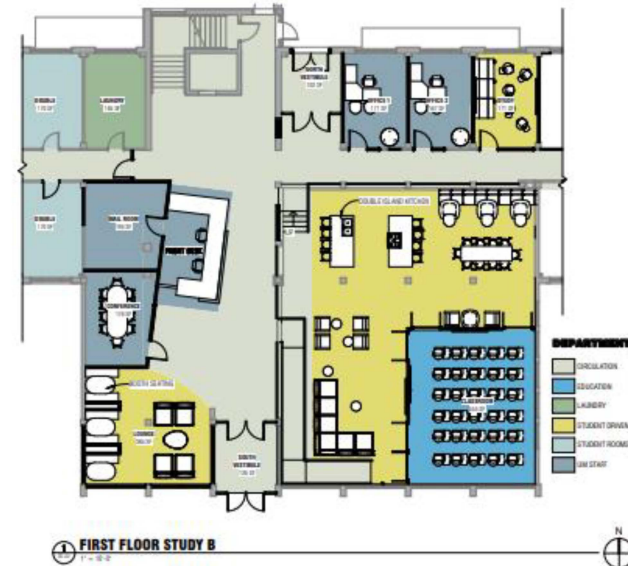
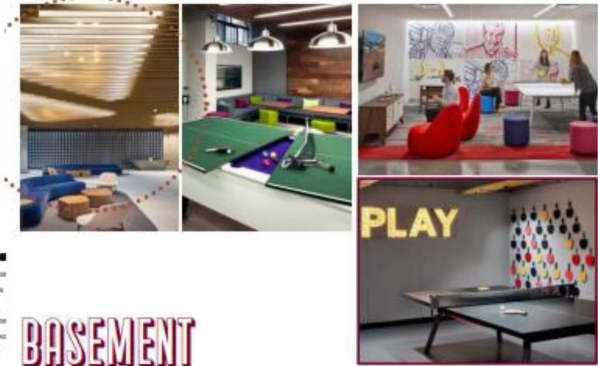
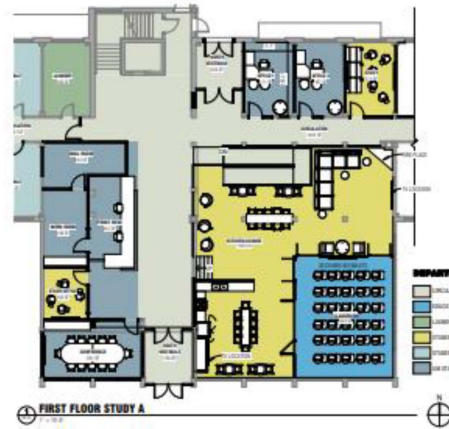
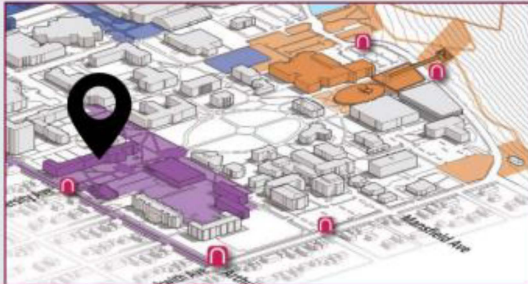

These diagrams and plans are preliminary Schematic Design plans and concepts, and do not reflect the finished design.



# UNIVERSITY OF MONTANA STUDENT LIFE MASTER PLAN

THE PROJECT

## RYMAN WALK

WHAT DOES IT  
ENTAIL?

The entire beloved experience of Ryman Walk from Arthur Street to the Grizzly Statue will be refreshed with new landscaping, new paving, branding, and a new plaza to connect the existing Corner Store to the new Dining Hall.

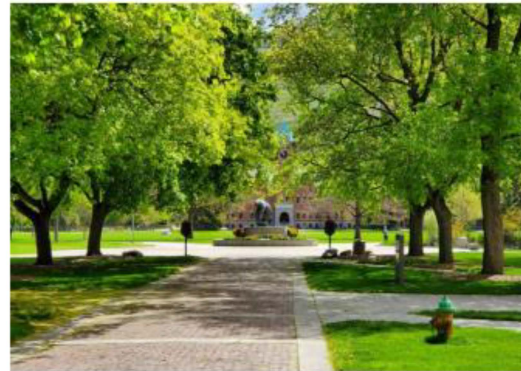
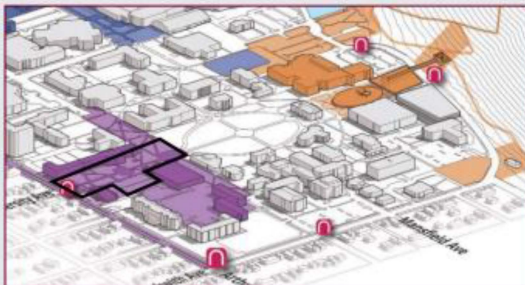



# UNIVERSITY OF MONTANA STUDENT LIFE MASTER PLAN

## THE PROJECT

# CORNER STORE

## WHAT DOES IT ENTAIL?

The Corner Store will remain in its current location while the rest of the Lommasson Center will be demolished. This building is newly remodeled, is in a prime location, and offers alternative food options to students.

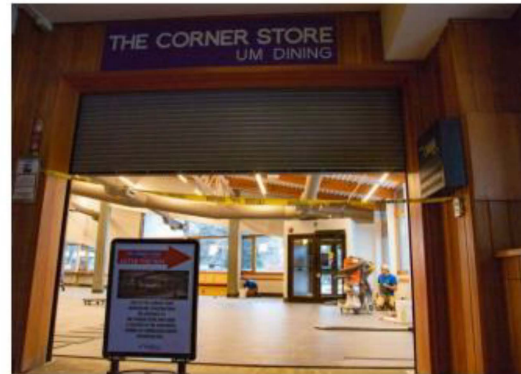
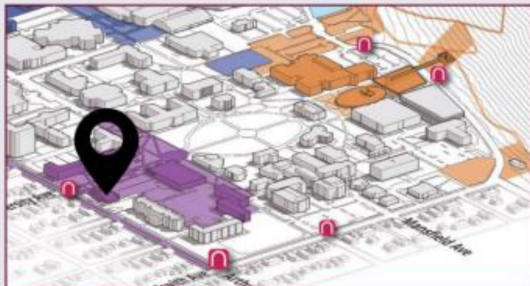



# UNIVERSITY OF MONTANA STUDENT LIFE MASTER PLAN

## THE PROJECT

# GATEWAY / MONUMENT SIGN

## WHAT DOES IT ENTAIL?

Adding a prominent and visible monument sign at the primary gateway to campus at Madison Street Bridge will give visitors a clear sense of having arrived to campus. This will provide further opportunity to reinforce the UM Brand.

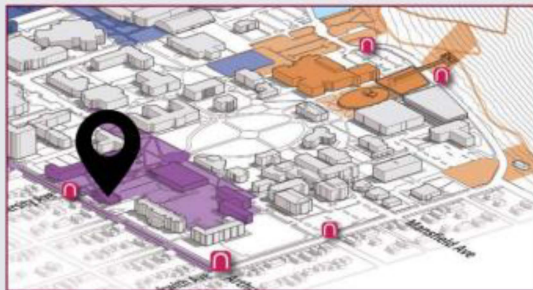

Examples of Monument Signs





# UNIVERSITY OF MONTANA STUDENT LIFE MASTER PLAN

## THE PROJECT

# ARTHUR STREET IMPROVEMENTS

## WHAT DOES IT ENTAIL?

Arthur Street is the primary street connecting the University with the community. Enhancing the presence of Arthur street will create a collegiate gateway the length of campus. Adding new lighting, signage and branding, bus shelters, center median, enhanced landscaping and a bike lane, the result will create a safer and more celebrated entry.

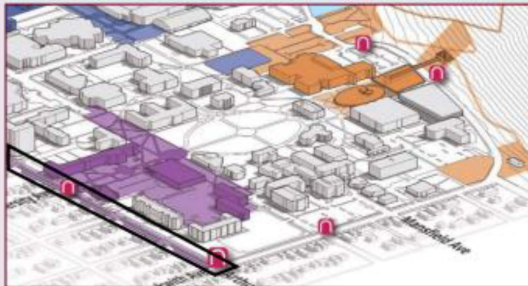

Arthur Street Inspiration from Stadium Way, WSU



Existing unwelcoming street edge at Arthur Ave



Existing Arthur Street





# UNIVERSITY OF MONTANA STUDENT LIFE MASTER PLAN

## THE PROJECT

# MEMORIAL GROVE EXTENSION

## WHAT DOES IT ENTAIL?

The beautiful Memorial Row walkway flanked with historic trees will be continued north to reinforce the connection of the heart of campus to the Adams Center and Clark Fork River. New widened paving and added trees will continue to the pedestrian bridge that connects the main campus to downtown.

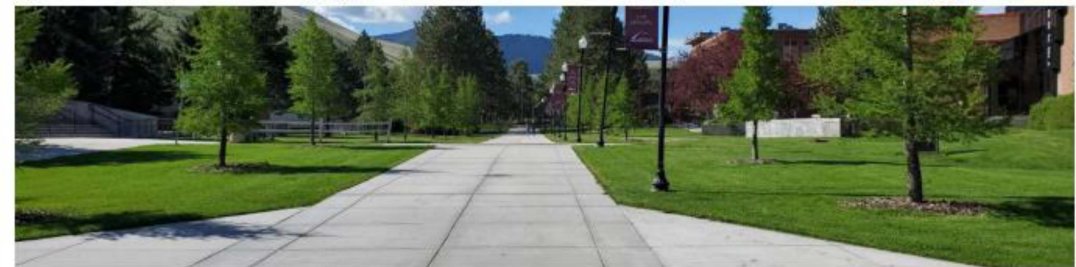
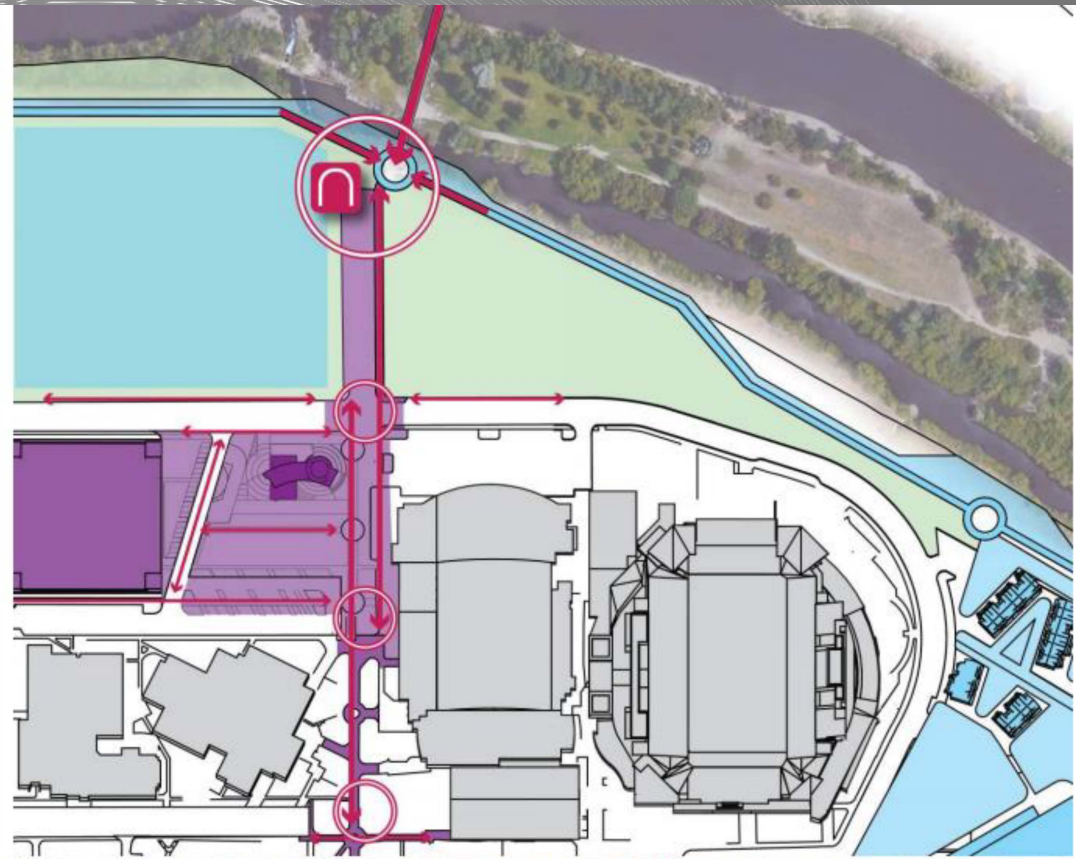
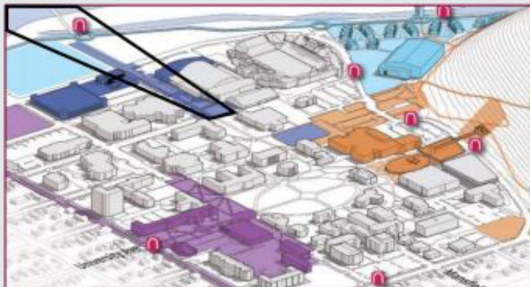

Memorial Grove





# UNIVERSITY OF MONTANA STUDENT LIFE MASTER PLAN

## THE PROJECT

# CAMPUS GATEWAY SIGNAGE

## WHAT DOES IT ENTAIL?

Signage and branding will be added at several primary campus gateways to create more prominent entries and draw visitors into campus. Locations include: 6th & Arthur, Arthur & University, Beckwith & Arthur and the existing pedestrian bridge.

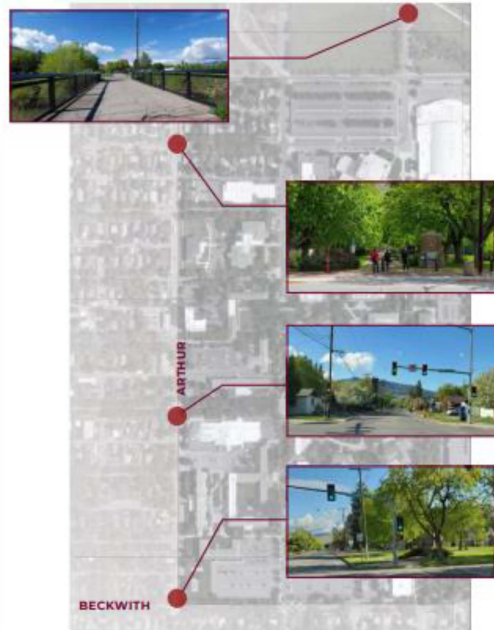
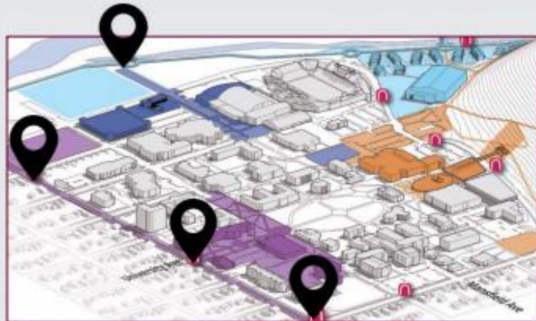

Examples of Gateway Signage





# UNIVERSITY OF MONTANA STUDENT LIFE MASTER PLAN

THE PROJECT

## BUILDING SIGNAGE

WHAT DOES IT  
ENTAIL?

New building identification signage will refresh the look and feel of campus signage, and will assist visitors and students in wayfinding.

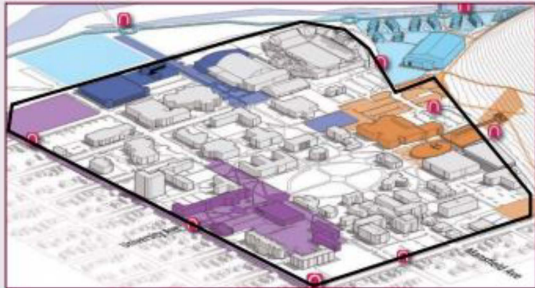

EXISTING CAMPUS  
WAYFINDING

- IDENTIFICATION**
- Monument Sign
  - Monument Gateway
  - Parking ID Signage
  - Building ID Signage
  - Barriers
  - Bus System Transportation Stop
  - Regulatory Signage
- DIRECTIONAL**
- Visitor Info & Parking Permit Sign
  - University of Montana
  - Missoula College
- INFORMATION**
- Campus Map
  - Visitor Information & Parking Permits Kiosk

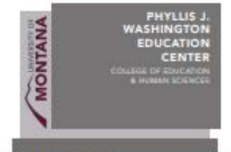

DESTINATION SIGN | BUILDING





# UNIVERSITY OF MONTANA STUDENT LIFE MASTER PLAN

## THE PROJECT

# CAMPUS PLAZA

## WHAT DOES IT ENTAIL?

To fully celebrate the campus' location at the edge of a mountain and trail system, a campus plaza will create an amphitheater space outside of the University Center building with a pedestrian bridge across Campus Drive. An accessible path will lead to a lookout below the 'M' for walkers to enjoy the view of campus for sunsets and photo ops.

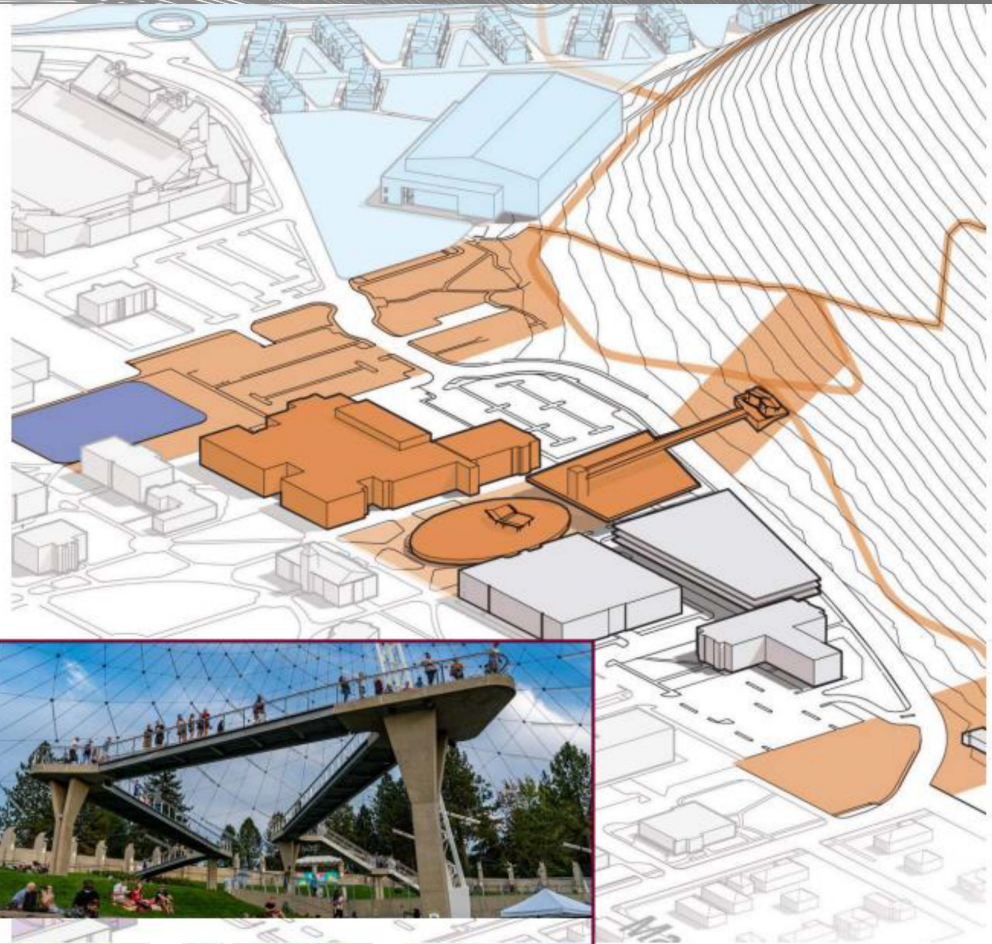
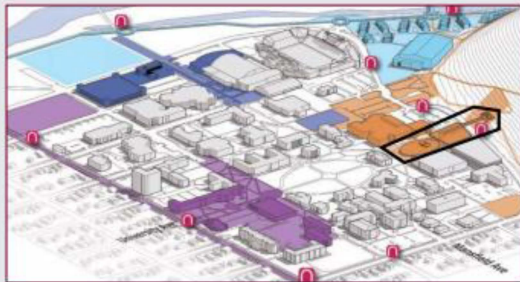



# UNIVERSITY OF MONTANA STUDENT LIFE MASTER PLAN

## THE PROJECT

# INFRASTRUCTURE IMPROVEMENTS

## WHAT DOES IT ENTAIL?

- Relocate Overhead Power
- Transformer Relocation
- Data Infrastructure

