

ALTERNATIVE 8

- INCLUDES BOTH NORTH-SOUTH AND EAST-WEST PARKING ORIENTATION
- PARKINGSTALLS IN LOT 20 AT 18' DEPTH
- PARKING AND DRIVE AISLE LOCATED OUTSIDE 100' SECURITY PERIMETER

* Does not yet account for ADA parking stall requirements. Quantities may change due to yet unknown site impacts, such as roundabout configurations at 7th and 11th and final IPF location.

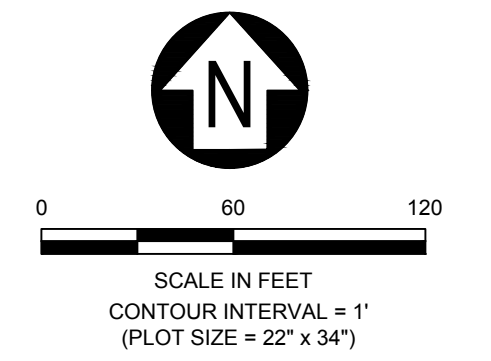

REVISION	DATE	DESCRIPTION

DESIGNER	PROJ. NO.
DRAWN	DATE
CHECKED	SURVEYED
	D&A, P.C.

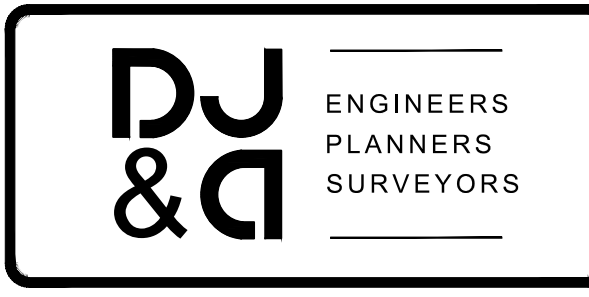

MONTANA STATE UNIVERSITY STADIUM PARKING LOT DESIGN

ALTERNATIVE 8

03/12/25 10:00 BACHELOR BANKER #1258.05 48181 STADIUM LOTS SURVEY & CONCEPT DESIGN DRAWINGS BY DESIGN MANAGER/PROJECT LEADER/DESIGNER/ARCHITECT/ENGINEER/PLANNER/SURVEYOR/CONSULTANT/GENERAL CONTRACTOR/CONCEPT DESIGN