



MSU-CAMPUS PLANNING,  
DESIGN, AND CONSTRUCTION  
MONTANA STATE UNIVERSITY  
1010 UNIVERSITY AVENUE  
BOZEMAN, MONTANA 59717-3000  
TEL: 406/994-2000

50% DESIGN DEVELOPMENT

MSU FACILITY RELOCATION



DESIGNED BY	DATE

REV.	DESCRIPTION	DATE



PPA # 220006  
TDB# 0224055  
AMS PROJ # 22069.03

SHEET TITLE  
CIVIL LAYOUT

SHEET  
C3.1

DATE  
15-12-2023

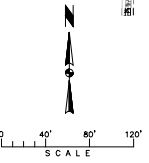
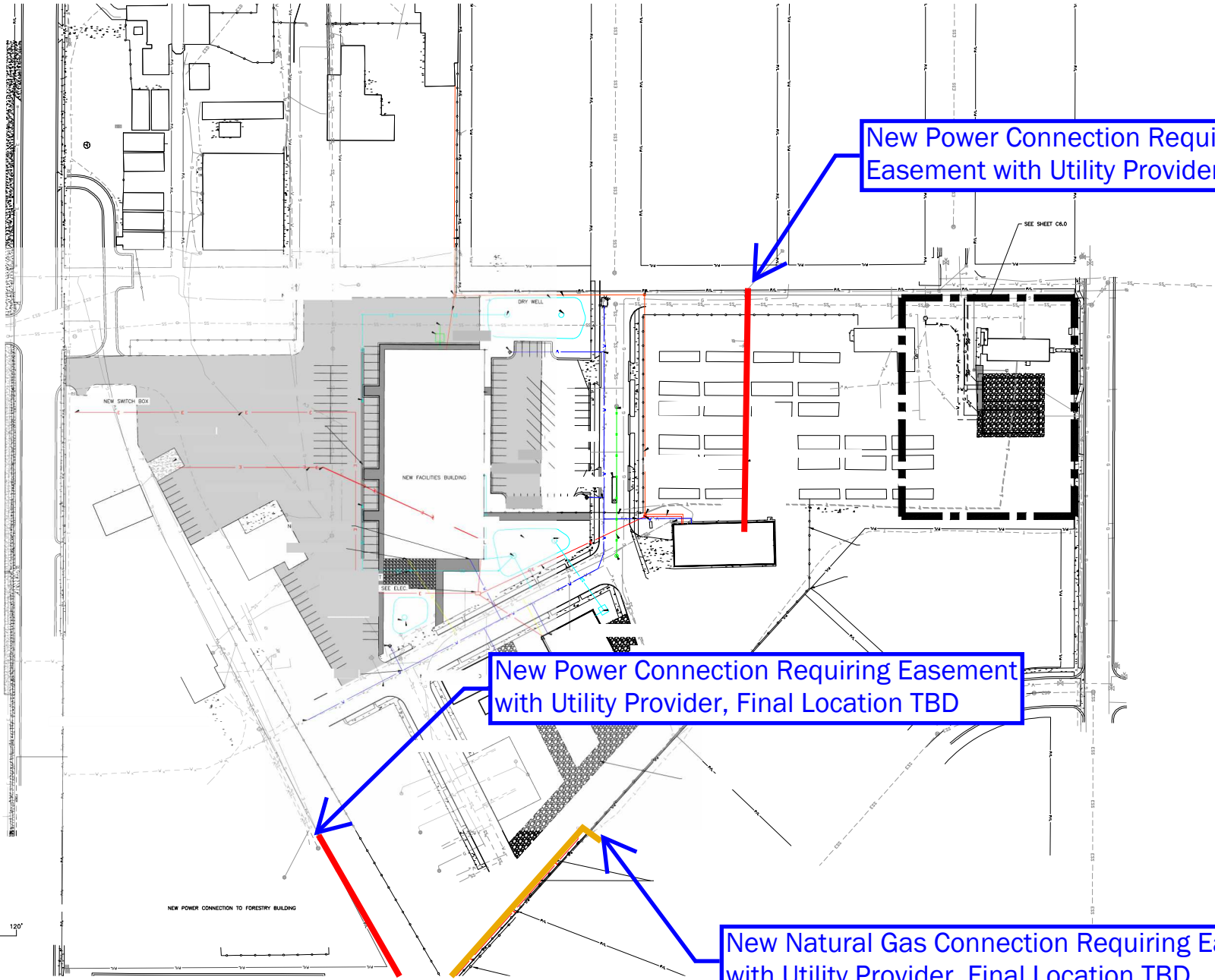

2023/12/15 10:00 AM C:\Users\jdoyle\OneDrive\Documents\2023\12\15\2023-12-15 10:00 AM.dwg

CITY OF BOZEMAN PERMIT SET  
NOT FOR CONSTRUCTION



MSU-CPDC  
MONTANA STATE UNIVERSITY  
BOZEMAN, MONTANA  
PHONE: 406.974.5413  
FAX: 406.974.5665

MSU 7TH AVENUE  
UTILITY TUNNEL



DRAWN BY: ZJL  
REVIEWED BY: ACH  
REV. DESCRIPTION DATE



PPA#22-0006

A & E #: 22059.30

TD&H # B22-055

SHEET TITLE  
FACILITY YARD 7TH  
AVENUE WATER  
OVERVIEW

SHEET  
C5.0

DATE  
04.05.2023

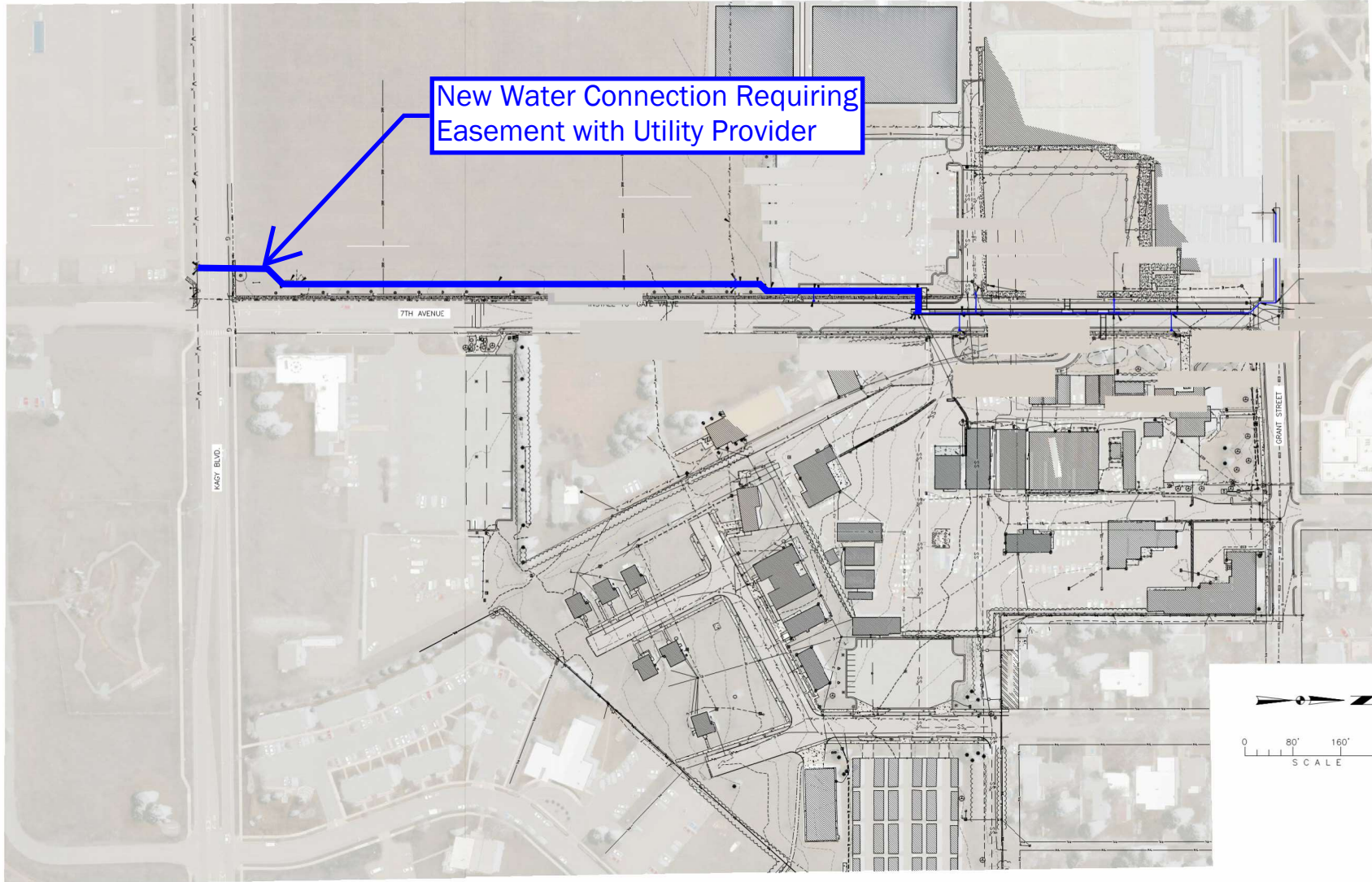

New Water Connection Requiring  
Easement with Utility Provider